

AIR CONDITIONER

PERFORMANCE

COOLING CAPACITY: 32,200 BTUH @ 131°F
RETURN AIR CONDITIONS: 95°F, 60% RH (MAX)
FREQUENCY: 50 Hz
ALTITUDE: SEA LEVEL
SENSIBLE HEAT RATIO: 0.8 (APPROX.)
CONDITIONED AIR SUPPLY: 960 CFM @ 1.0" W.C. ESP

HEATING CAPACITY: 9.4 kW (32,082 BTUH)
DEHUMIDIFYING CAPACITY: 50% RH (MAX)
FRESH AIR: 0-40 CFM (ADJ)
MAXIMUM OPERATING AMBIENT: 131°F
MINIMUM OPERATING AMBIENT (COOLING): -22°F
MINIMUM OPERATING AMBIENT (HEATING): -22°F

MECHANICAL

REFRIGERATION STAGES: ONE
COMPRESSOR: HERMETIC (SCROLL)
EVAPORATOR COIL: CU TUBES/ AL FINS
CONDENSER COIL: CU TUBES/ AL FINS
EXPANSION VALVE: TEV

CIRCULATING FAN: CENTRIFUGAL
CONDENSER FAN: PROPELLER
AIR FILTER: METAL (CLEANABLE)
FRAME AND PANELS: ALUM
METAL FINISHES: CARC (GREEN OR TAN)
WEIGHT: 550 LBS (APPROX)

ELECTRICAL

POWER: 220/380 VAC, 3 PHASE, 50 Hz (5-WIRE)
MAXIMUM POWER DRAW: 5 kW (COOLING), 10 kW (HEATING)
COMPRESSOR H.P.: 3 HP (NOMINAL)
CIRCULATING FAN MOTOR: SINGLE PHASE ODP
CONDENSER FAN MOTOR: SINGLE PHASE TEFC OR TEAO
MOTOR PROTECTION: CURRENT OVERLOAD OR THERMAL

HEATING STAGES: TWO
HEATING CONTROLS: THERMOSTAT
COOLING CONTROLS: THERMOSTAT
MODE SELECTOR SWITCH: HEAT-VENT-OFF-COOL
COOLING SAFETY SWITCHES: HIGH AND LOW PRESSURE
HEATING SAFETY SWITCHES: THERMAL CUTOFF

FEATURES (X)

HOT GAS BYPASS SYS. (X)	REMOTE CONTROLS (X)	FILTER WARNING LIGHT ()	MAIN POWER DISCONNECT ()
DEHUMIDIFYING ()	RFI SUPPRESSION ()	ELAPSED TIME INDICATOR ()	MOTORIZED FRESH AIR DAMPER ()
HUMIDIFYING ()	SERVICE SWITCHES ()	EXPLOSION PROOFING ()	TOOL KIT ()

OTHER SPECIFICATIONS

NOTES:

- 1) RATED TO 8000 FT. ALTITUDE WITH 3.5°F REDUCTION PER 1000 FT. ALTITUDE PER MIL-E-4158D, PARA. 3.2.32.1
- 2) AVAILABLE WITH STANDARD REMOTE BOX OR WITH DUAL SYSTEM CONTROL.
- 3) AVAILABLE EITHER LEFT OR RIGHT CONFIGURATION.

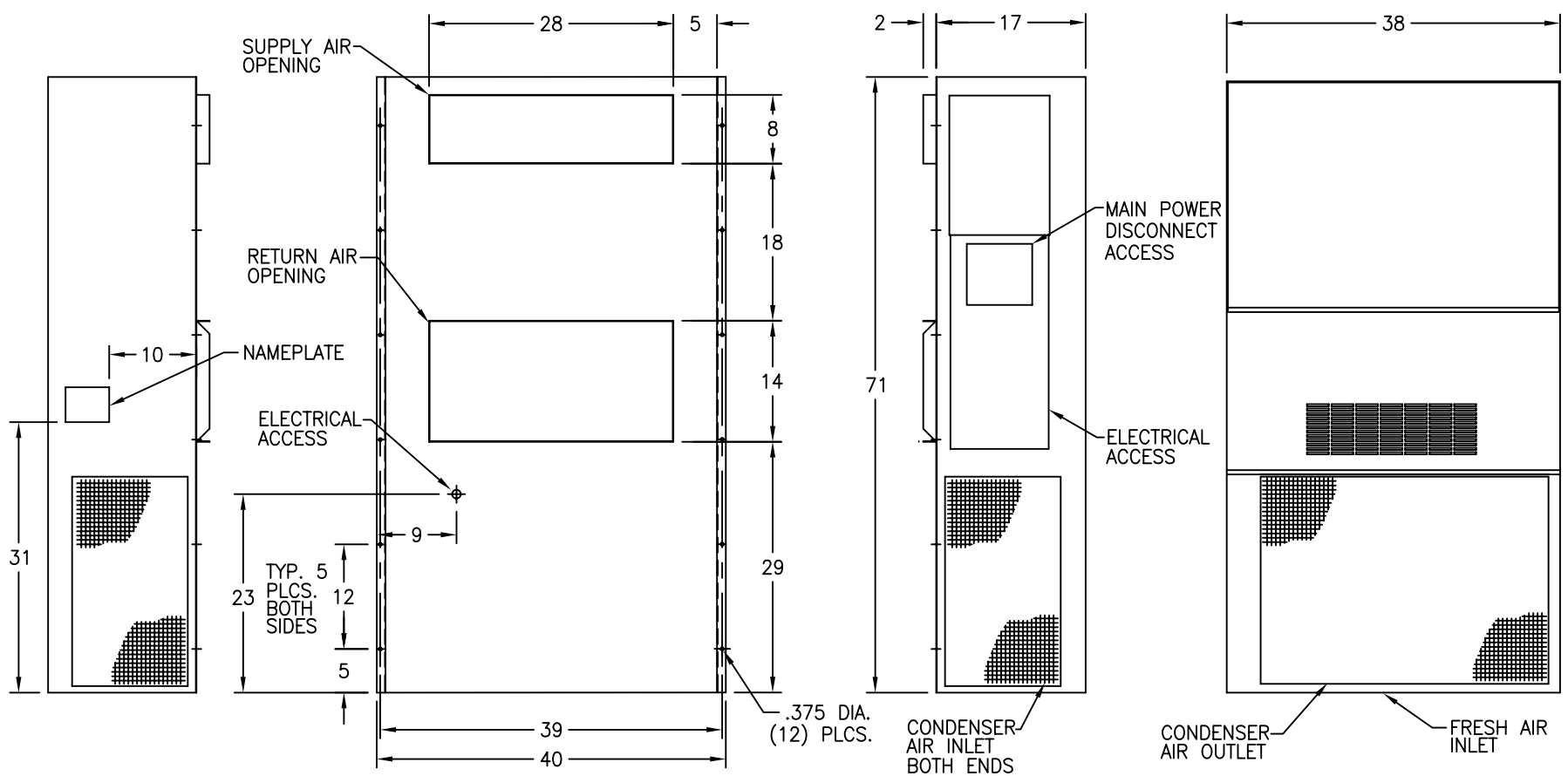

THIS DOCUMENT IS CONFIDENTIAL AND IS THE PROPERTY OF ENGINEERED ENVIRONMENTS, INC. IT CONTAINS INFORMATION WHICH IS PROPRIETARY. IT SHALL NOT BE USED, DISCLOSED, DUPLICATED, REPRODUCED, OR TRANSFERRED WITHOUT PRIOR WRITTEN PERMISSION OF ENGINEERED ENVIRONMENTS, INC.

C.A.G.E. CODE
OLHE3

DRAWN BY DL
 DATE 12/8/05
 CHECKED BY

UNIT MODEL NO.
 ECU 201142

DRAWING NO.
 ECU 201142
 SALES SHEET