

# AIR CONDITIONER

## PERFORMANCE

COOLING CAPACITY: 22,200 BTUH @ 131°F OAT  
 RETURN AIR CONDITIONS: 95°F/ 40% RH (MAX)  
 FREQUENCY: 50 Hz  
 ALTITUDE: SEA LEVEL  
 SENSIBLE HEAT RATIO: 0.8 (APPROX.)  
 CONDITIONED AIR SUPPLY: 800 CFM @ 0.2" W.C. ESP

HEATING CAPACITY: 3.7 kW (12,635 BTUH)  
 DEHUMIDIFYING CAPACITY: N/A  
 FRESH AIR: 0-20 CFM (ADJ)  
 MAXIMUM OPERATING AMBIENT: 131°F  
 MINIMUM OPERATING AMBIENT (COOLING): -22°F  
 MINIMUM OPERATING AMBIENT (HEATING): -22°F

## MECHANICAL

REFRIGERATION STAGES: ONE  
 COMPRESSOR: HERMETIC (SCROLL)  
 EVAPORATOR COIL: CU TUBES/ AL FINS  
 CONDENSER COIL: CU TUBES/ AL FINS  
 EXPANSION VALVE: TEV

CIRCULATING FAN: CENTRIFUGAL  
 CONDENSER FAN: PROPELLER  
 AIR FILTER: METAL (CLEANABLE)  
 FRAME AND PANELS: ALUM  
 METAL FINISHES: CARC (GREEN OR TAN)  
 WEIGHT: 450 LBS (APPROX.)

## ELECTRICAL

POWER: 380 VAC, 3-PHASE, 50 Hz (5 WIRE)  
 MAXIMUM POWER DRAW: 3.1 kW (COOLING), 4.0 kW (HEATING)  
 COMPRESSOR H.P.: 2 HP (NOMINAL)  
 CIRCULATING FAN MOTOR: SINGLE PHASE, ODP  
 CONDENSER FAN MOTOR: THREE PHASE, TEFC OR TEAO  
 MOTOR PROTECTION: CURRENT OVERLOAD AND/OR THERMAL

HEATING STAGES: ONE  
 HEATING CONTROLS: THERMOSTAT  
 COOLING CONTROLS: THERMOSTAT  
 MODE SELECTOR SWITCH: HEAT-OFF-COOL  
 COOLING SAFETY SWITCHES: HIGH AND LOW PRESSURE  
 HEATING SAFETY SWITCHES: THERMAL CUTOFF

## FEATURES (X)

HOT GAS BYPASS SYS. ( X )	REMOTE CONTROLS ( )	FILTER WARNING LIGHT ( )	MAIN POWER DISCONNECT ( )
DEHUMIDIFYING ( )	RFI SUPPRESSION ( )	ELAPSED TIME INDICATOR ( )	MOTORIZED FRESH AIR DAMPER ( )
HUMIDIFYING ( )	SERVICE SWITCHES ( )	EXPLOSION PROOFING ( )	TOOL KIT ( )

## OTHER SPECIFICATIONS

### NOTES:

- 1) RATED TO 8000 FT. ALTITUDE WITH 3.5°F REDUCTION PER 1000 FT. ALTITUDE PER MIL-E-4158D, PARA. 3.2.32.1
- 2) SUPPLIED WITH COMMERCIAL THERMOSTAT

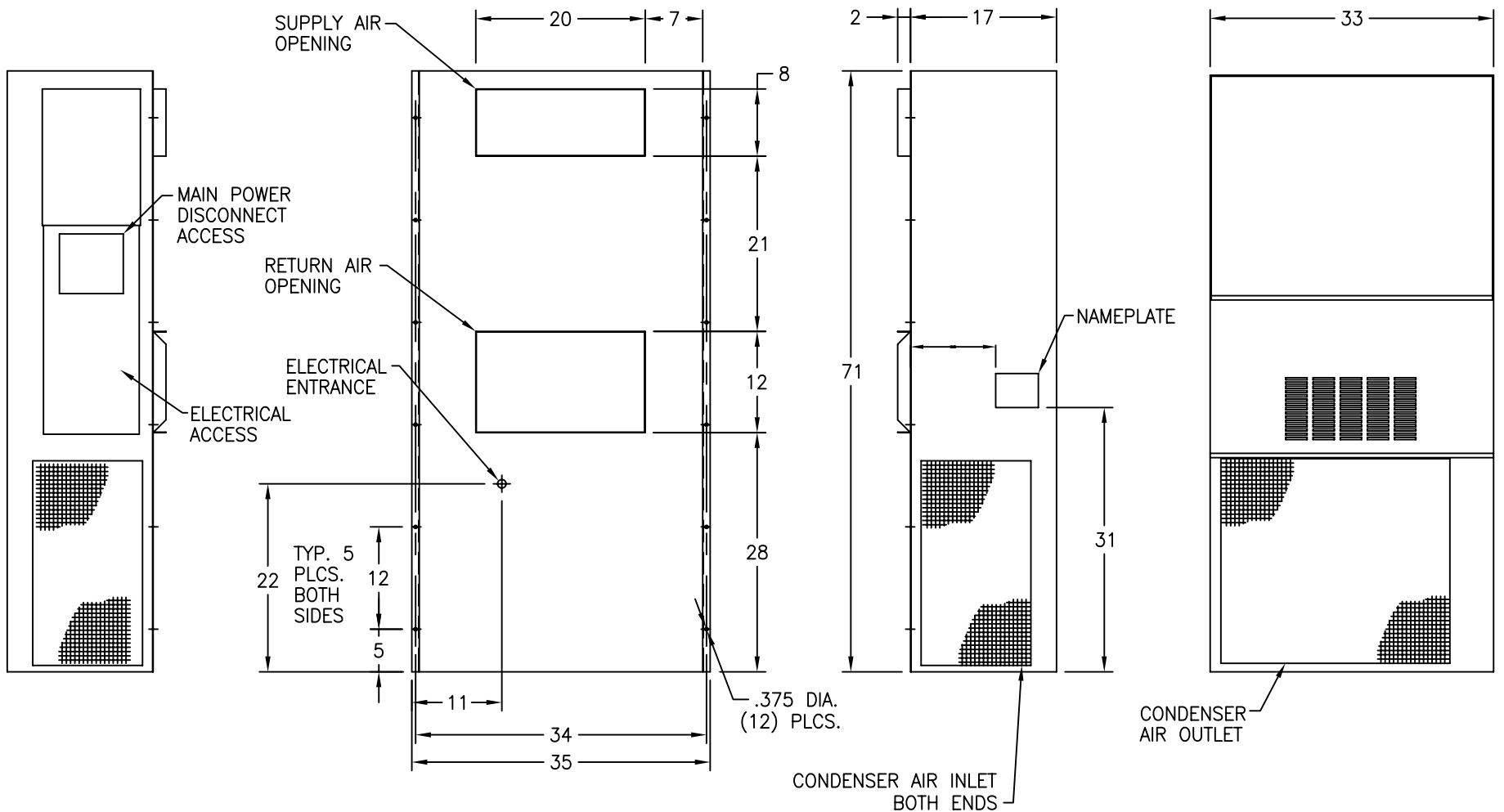

THIS DOCUMENT IS CONFIDENTIAL AND IS THE PROPERTY OF ENGINEERED ENVIRONMENTS, INC. IT CONTAINS INFORMATION WHICH IS PROPRIETARY. IT SHALL NOT BE USED, DISCLOSED, DUPLICATED, REPRODUCED, OR TRANSFERRED WITHOUT PRIOR WRITTEN PERMISSION OF ENGINEERED ENVIRONMENTS, INC.

C.A.G.E. CODE  
**OLHE3**

DRAWN BY  
 DL  
 CHECKED BY  
 DATE  
 12/8/05

UNIT MODEL NO.  
 ECU 151141

DRAWING NO.  
 ECU 151141  
 SALES SHEET